

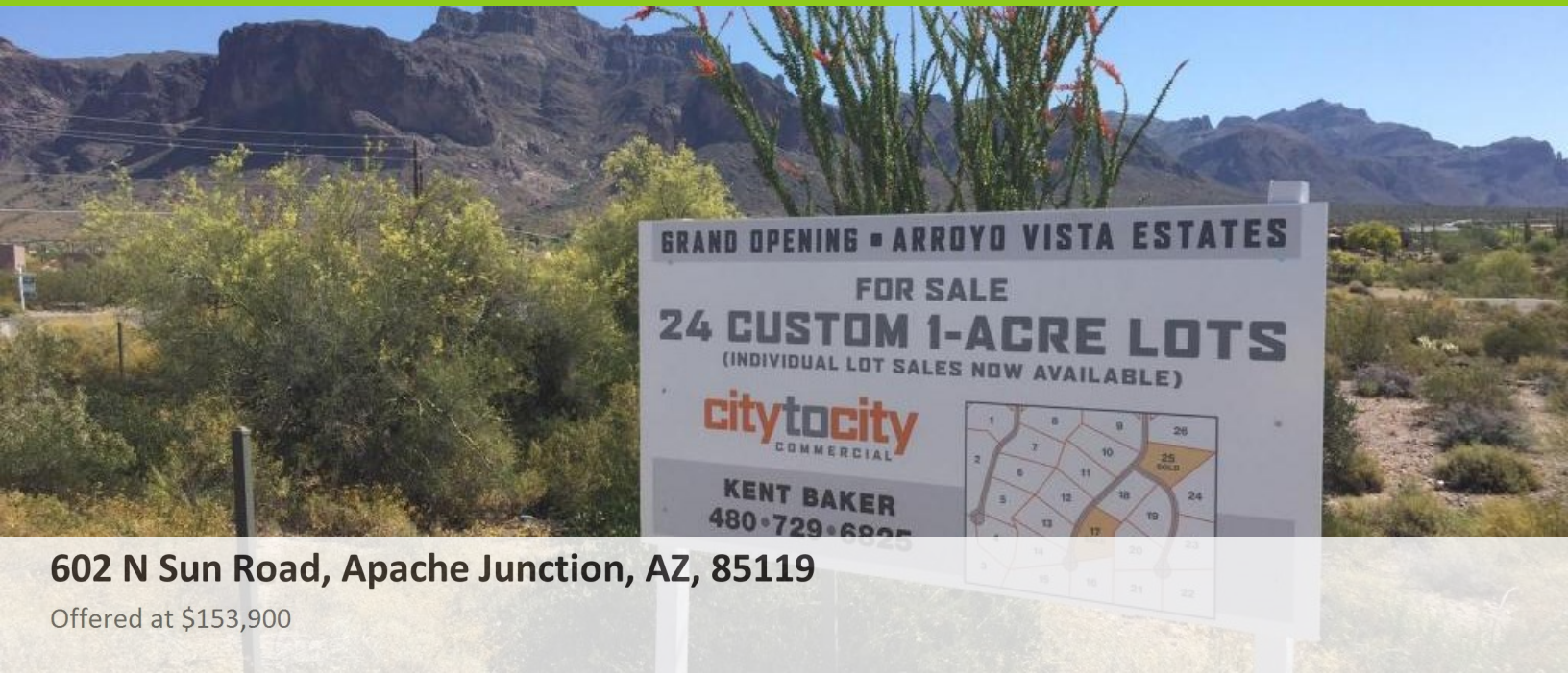





# Residential Lot - Apache Junction, AZ



## 602 N Sun Road, Apache Junction, AZ, 85119

Offered at \$153,900

Grand Opening Pricing Incredible views from this gated subdivision at the base of the Superstition Mountains. Enjoy some of the most spectacular views available in all of Arizona. This site has 26 custom homes sites with paved streets, electric, water and services to the lot lines. Take your pick of the best lot available with Grand Opening pricing, we do expect pricing to increase as the project gets underway. Note: Owner still needs to complete electronic gates and perimeter wrought iron fencing however the work is already bonded.

 0 Bedrooms
 0 Bathrooms
 Unknown sqft sqft
 1.05 acre (lot size)
 Built: Unknown year



Scan above on mobile device  
for directions to this listing

Kent Baker  
(480) 729-6825  
kbaker@citytocitycre.com



MLS# 5592057 All information deemed reliable but not guaranteed. If your property is currently listed this is not meant as a solicitation.  
©2019 Pinput.com - Contact info@pinput.com for PDF listing creation.